

Flymo®

HVT52

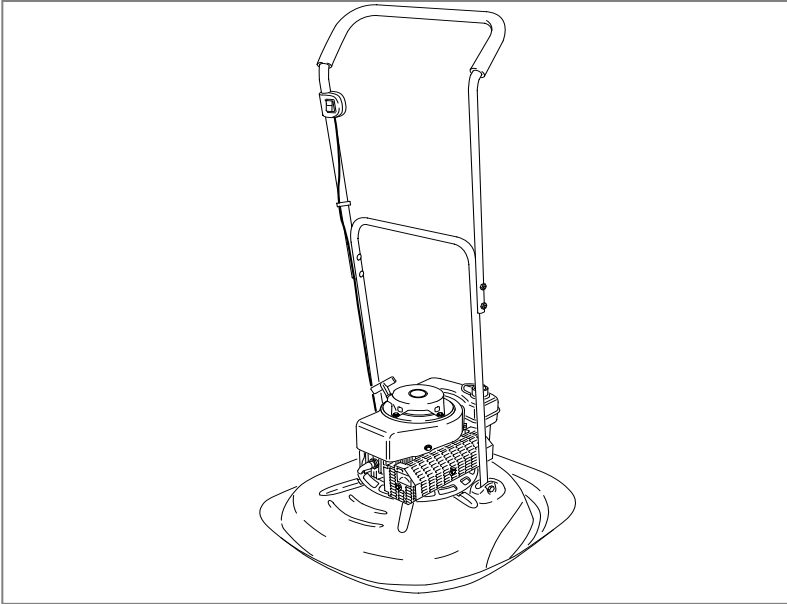

GB

IMPORTANT INFORMATION

Read before use and retain for future reference

D

WICHTIGE INFORMATION

Bitte vor dem Benutzen des Gerätes durchlesen und gut aufbewahren

F

RENSEIGNEMENTS IMPORTANTS

A lire avant usage et à conserver pour référence ultérieure

NL

BELANGRIJKE INFORMATIE

Leest u deze informatie voor het gebruik en bewaar ze voor toekomstige raadpleging

N

VIKTIG INFORMASJON

Les bruksanvisningen før bruk og oppbevar denne for senere bruk.

SF

TÄRKEÄÄ TIETOA

Lue tämä ennen käyttöä ja säilytä myöhempää tarvetta varten

S

VIKTIG INFORMATION

Läs anvisningarna före användningen och spara dem för framtida behov

DK

VIGTIGE OPLYSNINGER

De bør læse dette før brug og gemme til senere henvisning

E

INFORMACIÓN IMPORTANTE

Léase antes de utilizar y consérvela como referencia en el futuro

P

INFORMAÇÕES IMPORTANTES

Leia antes de utilizar e guarde para consulta futura

I

INFORMAZIONI IMPORTANTI

Leggere prima dell'uso e conservare per consultazione futura

(GB) INSTRUCTION MANUAL
(D) BEDIENTUNGSANWEISUNG
(F) MANUEL D'UTILISATION
(NL) GEBRUIKSAANWIJZING

(N) BRUKSANVISNING
(SF) KÄYTTÖHIE
(S) BRUKSANVISNING
(DK) BRUGSANVISNING

(E) MANUAL DE INSTRUCCIONES
(P) INSTRUÇÕES PARA O USO
(I) ISTRUZIONI PER L'USO

GB - CONTENTS

1. Start/Stop Switch
2. Upper Handle
3. Tie Wrap
4. Washer
5. Locknut
6. Upper Handle Fixing Bolt (X4)
7. Lower Handle Fixing Bolt (x2)
8. Starting Handle
9. Fuel Tank Cap & Air Vent Screw
10. Air Filter
11. Fuel tap & Choke Control
12. 8 spare cutting lines (coloured yellow)
13. Spark Plug Lead
14. Instruction Manual
15. International Service Directory

ENGLISH PAGES (2-9)**D - INHALT**

1. Start-/Stoppeschalter
2. Oberer Griff
3. Kabelhalter
4. Unterlegscheibe
5. Sicherungsmutter
6. Befestigungsbolzen, oberer Griff (x4)
7. Befestigungsbolzen, unterer Griff (x2)
8. Starterseil
9. Einfüllverschluss & Entlüftungsschraube
10. Luftfilter
11. Kraftstoffhahn & Chokeregulierung
12. 8 Ersatzfaden (gelb)
13. Zündkerzenzuleitung
14. Bedienungsanleitung
15. Internationales Kundendienstverzeichnis

DEUTSCHE SEITEN (10-17)**F - TABLE DES MATIÈRES**

1. Interrupteur de marche/arrêt
2. Poignée supérieure
3. Attache
4. Rondelle
5. Contre-écrou
6. Boulon de fixation de la poignée supérieure (x4)
7. Boulon de fixation de la poignée inférieure (x2)
8. Poignée de démarrage
9. Capuchon de réservoir de combustible & vis d'évent
10. Filtre à air
11. Robinet de combustible & commande de starter
12. 8 lignes de coupe de réserve (de couleur jaune)
13. Fil de bougie
14. Manuel d'instructions
15. Répertoire d'entretien international

LES PAGES EN LANGUE FRANÇAISE (18-25)**NL - INHOUD**

1. Start/Stopschakelaar
2. Bovenste duwboom
3. Bindveter
4. Borgschijfe
5. Borgmoer
6. Bevestigingsbout voor bovenste duwboom (x4)
7. Bevestigingsbout voor onderste duwboom (x2)
8. Starthendel
9. Dop voor brandstoftank en schroef voor luchtuitlaat
10. Luchtfilter
11. Brandstofkraan en carburateurcontrole
12. 8 extra maaikoorden (geel)
13. Boegiekabel
14. Handboek
15. Internationale service-adressen

NEDERLANDSE PAGINA'S (26-33)**N - INNHOLD I ESKEN**

1. Start/Stopp bryter
2. Øvre håndtak
3. Kabel strips (2 stk)
4. Skiver (8 stk)
5. Låsemutter (6 stk)
6. Festebolt for øvre håndtak (4 stk)
7. Festebolt for nedre håndtak (2 stk)
8. Starthåndtak/snor
9. Drivstofftanklokk (bensinlokk) & lufteventil
10. Luftfilter
11. Drivstoffkran (drivstoffuttak) & choke kontroll
12. Ekstra trad (8 stk) (gule)
13. Ledning/hette for tennplugg
14. Bruksanvisning
15. Servicetajsonliste

NORSKE SIDER (34-41)**SF - SISÄLTÖ**

1. käynnistys/pysäytys-
atkaisin
2. ylävarsi
3. kiinnityskappale
4. pultin välirengas
5. lukitusmutteri
6. ylävarren kiinnityspultti (4 kpl)
7. alavarren kiinnityspultti (2 kpl)
8. käynnistyskahva
9. polttoainesäiliön korkki ja ilma-aukon ruuvi
10. ilmansuodatin
11. polttoainehana ja rikastimen säätö
12. kahdeksan (keltaista) varaleikkusuosimaa
13. sytytystulpan johdin
14. käyttöohjeet
15. kansainvälinen Flymo/Partner-huoltohakemisto.

SUOMALAISET SIVUT (42-49)**S - INNEHÅLL**

1. Start/stoppkontakt
2. Øvre handtag
3. Kabelband
4. Bricka
5. Låsmutter
6. Øvre handtagets fästbultar (4 st)
7. Nedre handtagets fästbultar (2 st)
8. Starthandtag
9. Tanklock & luftventilationskruv
10. Luftfilter
11. Bränslekran och chokereglage
12. 8 kaplinor i reserv (gulårgåde)
13. Tändkabel
14. Instruktionsbok
15. Internationell servicekatalog

SVENSKA SIDOR (50-57)**DK - INDHOLD**

1. Start/stopkontakt
2. Øvre håndtag
3. Kabelklemme
4. Spændskive
5. Låsemøtrik
6. Fastgøringsbolt til øvre håndtag (4 stk.)
7. Fastgøringsbolt til nedre håndtag (2 stk.)
8. Starthåndtag
9. Benzindæksel og luftventilskruer
10. Luftfilter
11. Benzinhane og chokerregulering
12. 8 ekstra klippesnører (gule)
13. Tændrørsledning
14. Brugsvejledning
15. International servicetelefonbog

DANSKE SIDER(58-65)**E - CONTENIDO**

1. Interruptor de contacto
2. Manillar superior
3. Amarra
4. Arandela
5. Tuerca inaflojable
6. Perno de fijación de manillar superior
7. Perno de fijación de manillar inferior
8. Manilla de arranque
9. La tapa del tanque de combustible y el tornillo del respiradero de aire.
10. Filtro de aire
11. Llave de combustible y el control del ahogador
12. 8 cuerdas para cortar de repuesto (color amarillo)
13. Cable de la bujía
14. Manual de Instrucciones
15. Directorio de Servicio Internacional

PAGINAS EN CASTELLANO (66-73)**P - LEGENDA**

1. Interruptor de Ligar/Desligar
2. Cabo Superior
3. Presilha
4. Arruela
5. Porca de Aperto
6. Parafuso de Fixação do Cabo Superior (x4)
7. Parafuso de Fixação do Cabo Inferior (x2)
8. Pega de Arranque
9. Tampa do depósito de combustível e parafuso da ventilação
10. Filtro de Ar
11. Torneira do combustível e controle do redutor de ar
12. 8 linhas de corte sobresselentes (de cor amarela)
13. Fio da vela de ignição
14. Manual de Instruções
15. Lista de Assistência Internacional

PÁGINAS PORTUGUESAS (74-81)**I - NOMENCLATURA**

1. Interruttore acceso/spento
2. Manico superiore
3. Fermo
4. Rondella
5. Controdado
6. Bullone di fissaggio per manico superiore (x4)
7. Bullone di fissaggio per manico inferiore (x2)
8. Maniglia di avviamento
9. Tappo serbatoio del carburante e vite passaggio aria
10. Filtro aria
11. Rubinetto carburante e comando dell'aria
12. 8 lamelle di scorta (colore giallo)
13. Conduttore candela
14. Manuale d'istruzioni
15. Elenco centri assistenza internazionali

ITALIANO (82-89)

(GB)	CARTON CONTENTS	(N)	KARTONGENS INNHold	(E)	CONTENIDO DEL CARTON
(D)	KARTONINHALT	(SF)	PAKETIN SISÄLTÖ	(P)	LEGENDAS DOS DESENHOS
(F)	CONTENU DU CARTON	(S)	FÖRPACKNINGENS INNEHÅLL	(I)	DE CARTONE
(NL)	INHOUD	(DK)	KARTONINDHOLD		

A

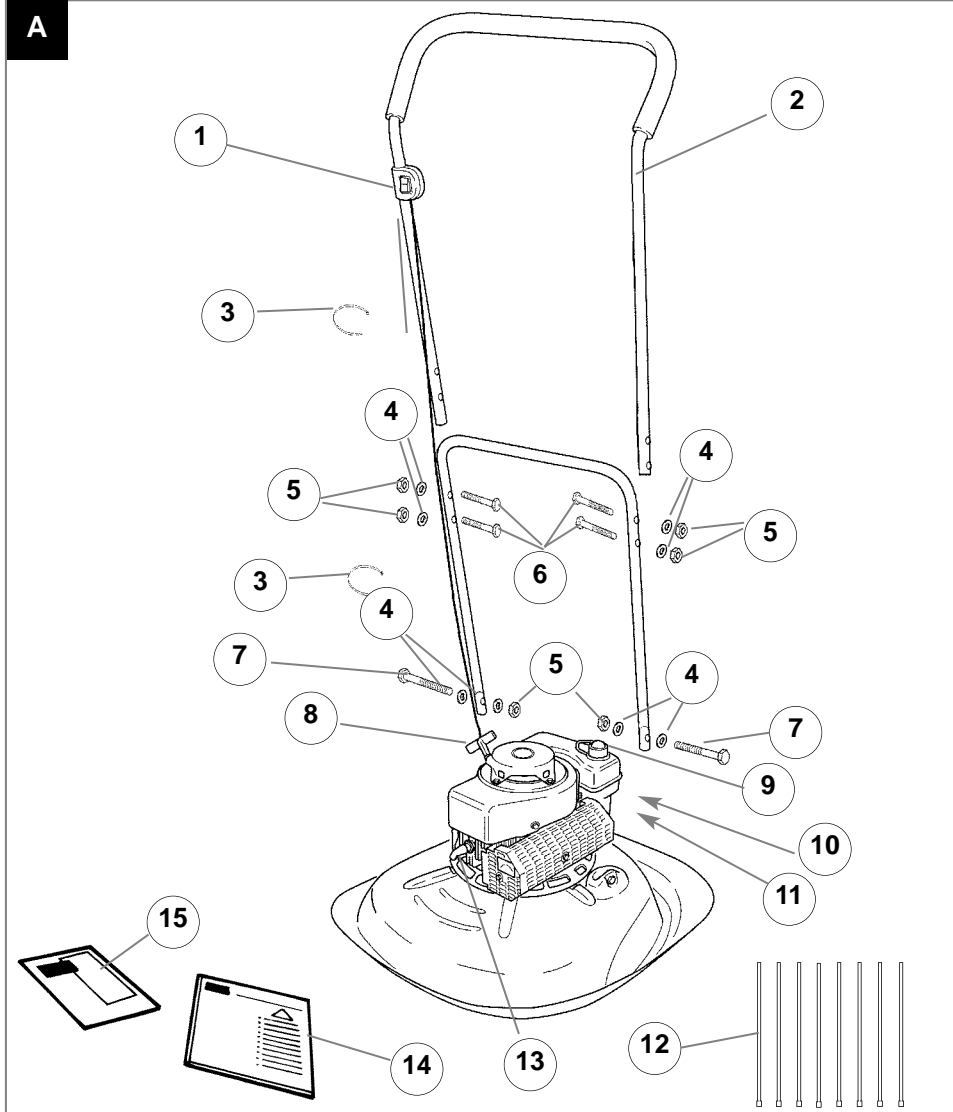



If not used properly this trimmer can be dangerous! This trimmer can cause serious injury to the operator and others, the warnings and safety instructions must be followed to ensure reasonable safety and efficiency in using this trimmer. The operator is responsible for following the warning and safety instructions in this manual and on the trimmer.

Explanation of Symbols on the HVT52



Warning



Read the user instructions carefully to make sure you understand all the controls and what they do.



The use of ear protection is recommended.



Disconnect the spark plug before attempting any maintenance, cleaning or adjustment, or if you are going to leave the trimmer unattended for any period.



Never allow children or people unfamiliar with these instructions to use the trimmer. Local regulations may restrict the age of the operator.



Never use, or attempt to fit, a metal/bar blade with this product.

General

1. Only use the trimmer in the manner and for the functions described in these instructions.
2. Keep bystanders away. Do not trim whilst people, especially children or pets, are in the trimming area.
3. Never operate the trimmer when you are tired, ill or under the influence of alcohol, drugs or medicine.
4. The operator or user is responsible for accidents or hazards occurring to other people or their property.

Fuel Safety

1. WARNING - Petrol is highly flammable

- Store fuel in a cool place in a container specifically designed for the purpose.
- Only use a container that is specially designed for mixing fuel.
- Your trimmer has a 2-stroke engine which runs on fuel of 1 part of oil to 25 parts of petrol.
- Do not use standard 2-stroke mixture as supplied by garages, neat petrol or multi grade oil.
- Use a good quality 2-stroke oil or a quality SAE 30 oil mixed with fresh REGULAR grade unleaded petrol.
- Refuel outdoors only and do not smoke while refuelling.
- Wipe dirt and grass clippings from the fuel tank filler cap to avoid getting dirt into the fuel tank.
- Add fuel **BEFORE** starting the engine. Never remove the cap of the fuel tank or add fuel while the engine is running or when the engine is hot.
- If petrol is spilled, do not attempt to start the engine but move the machine away from the area of spillage and avoid creating any source of ignition until petrol vapours have dissipated.
- Never use stale fuel left from last season or fuel which has been stored for long periods.
- Replace all fuel tanks and container caps securely.
- Fuel should be stored in a cool place away from naked flames.
- Your carburettor is pre-set. Normally no further adjustment is required.

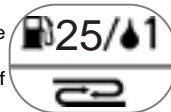

Preparation

1. Do not trim barefoot or in open sandals. Always wear suitable clothing, gloves, and stout shoes.
2. Make sure the area to be cut is clear of sticks, stones, bones, wire and debris; they could be thrown by the cutting line.
3. Before using always visually inspect to see that cutting lines, disc bolts and disc assembly are not worn or damaged. Replace worn or damaged cutting lines together with their fixings in sets to preserve balance.
4. Replace faulty mufflers.

Use

1. Do not operate the engine in a confined space where exhaust fumes (carbon monoxide) can collect.
2. Use the trimmer only in daylight or good artificial light.
3. Avoid operating your trimmer in wet grass, where feasible.
4. Take care in wet grass, you may lose your footing.
5. On slopes, be extra careful of your footing and wear non-slip footwear.
6. Exercise extreme caution when changing direction on slopes.
7. Trimming on banks and slopes can be dangerous. and you should use extreme caution if using the trimmer in this manner. Please see further important information below.
8. Do not walk backwards when trimming, you could trip. Walk never run.
9. Never cut grass by pulling the trimmer towards you.
10. Stop the engine before pushing the trimmer across surfaces other than grass and when transporting the trimmer to and from the area to be mowed.
11. Do not overspeed the engine or alter governor settings. Excessive speed is dangerous and shortens trimmer life.
12. Always start the trimmer carefully with feet well away from the cutting lines.
13. Do not tilt the trimmer when starting the engine, except if the trimmer has to be tilted for starting. In this case, do not tilt more than absolutely necessary and lift only the part which is away from the operator. Always ensure that both hands are in the operating position before returning the appliance to the ground.
14. Never pick up or carry a trimmer while the engine is running
15. Spark plug lead may be hot - handle with care.
16. Do not attempt any maintenance on your trimmer when the engine is hot.
17. Cutting disc continues to rotate after the machine is switched off. Wait until all machine components have completely stopped before touching them.
18. Switch off the engine, wait until the cutting disc has stopped and disconnect the spark plug lead:-
 - before leaving the trimmer unattended for any period;
 - before refuelling
19. Switch off the engine, wait until the cutting disc has stopped, close the air vent screw, close the fuel tap and disconnect the spark plug lead.
 - before clearing a blockage;
 - before checking, cleaning or working on the trimmer;
 - if you hit an object. Do not use your trimmer until you are sure that the entire trimmer is in a safe operating condition;
 - if the trimmer starts to vibrate abnormally. Check immediately.

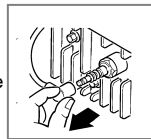
**Maintenance and storage**

1. Keep all nuts, bolts and screws tight to be sure the trimmer is in safe working condition.
2. Replace worn or damaged parts for safety.
3. Only use the replacement cutting disc, cutting line, disc bolt, spacer and impeller specified for this product.
4. Never store the trimmer with fuel in the tank inside a building where fumes can reach an open flame or spark.
5. Allow the engine to cool before storing in any enclosure.
6. To reduce fire hazard, keep the engine, muffler and fuel storage area free of grass, leaves or excessive grease.
7. If the fuel tank has to be drained, this should be done outdoors.
8. Be careful during adjustment of the machine to prevent entrapment of the fingers between moving parts and fixed parts of the machine.

USE ON STEEP SLOPES

When operating the trimmer on banks or steep slopes it is important that the feet of the operator remain firmly on level ground. Where it is not possible we recommend that the operator use a rope kit specifically designed for this purpose. Any operator so doing must be adequately trained in the operation of the trimmer in this mode. Further please note that it is important that every operator carries out a risk assessment or any site before operation commences. More details of how to use a rope kit or how to obtain one is available from the Manufacturer or your local Distributor.

Product Rating Label

B Product Number

Model Number

Serial Number

Date of Purchase

Place of Purchase

•PLEASE KEEP PROOF OF PURCHASE•

Every Flymo product is uniquely identified by a silver and black product rating label.

To ensure you have full product information when obtaining spares or advice from one of our approved service centres, or if you need to contact Flymo/Partner's own customer service department, you should make a note in the space provided of the information shown in fig.B. It will also be useful to make a note of the date and place of purchase before you return your guarantee card.

Fuel Mixing Instructions

1. Ensure mixing bottle and cap are clean and standing on a level surface.
 2. Add fresh regular grade unleaded petrol up to the 1 litre mark on the bottle.
 3. Add a good quality 2 stroke oil, to the 25 : 1 mark (40 ml of oil) on the bottle.
 4. Screw cap on, shake container until petrol and oil are thoroughly mixed.
 5. Clean fuel tank filler cap and fill fuel tank.
- **UK ONLY:-** Flymo/Partner manufacture a specially designed fuel mixing bottle. For further information contact your local Flymo/Partner Service Centre/Stockist or contact the Flymo/Partner Customer Careline on 01325 300303

Assembly and Adjustment

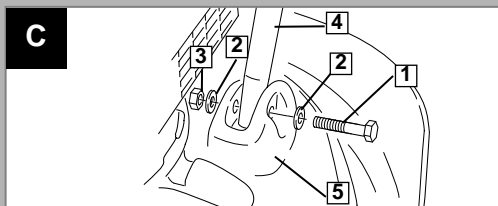

Assembly of lower handle to deck (Fig C)

With the trimmer on the ground:-

1. Remove the bolts (C1), washers (C2) and lock nuts (C4) from the polythene bag.
2. Place one washer (C2) on to the bolt (C1) and secure the lower handle (C4) by placing bolt (C1) through deck bracket (C5) and lower handle (C4).
3. Place washer (C2) on bolt and secure with lock nut (C3).

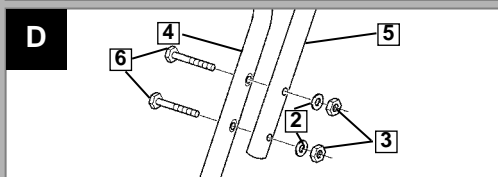

Assembly of upper handle to lower handle (Fig D)

Assemble upper handle (D5) to lower handle (D4) by fitting bolts (D6) and washers (D2) and securing with lock nuts (D3).

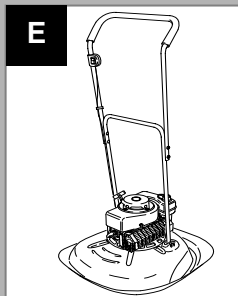

Handle Position

The handle position can be altered by moving it forward for the park position (Fig E) or back for the trimming position (Fig F).

Starting and Stopping

Before Starting your Trimmer

Filling the Fuel Tank

1. Clean around fuel cap (See fig A).
2. Remove cap.
3. Add fuel mix (See Fuel mixing instructions)
4. Never use stale fuel left from last season or fuel which has been stored for long periods.
5. Refit fuel tank cap and wipe up any spilled fuel.

To Start your Trimmer

1. Move the handle to the parking position (Fig E).
2. Open the fuel tank air vent screw See Fig. G.
3. Open the fuel tap (H1).
4. Connect the spark plug lead. See fig. J.
5. Set the choke control lever (H2) to 'cold start' when the engine is cold, or 'normal' when the engine is hot.
6. Move the start/stop switch to 'start' position See Fig K.
7. Place your right foot on the deck and grasp the top of the lower handle with your left hand. Tilt the trimmer towards you. See fig L. This prevents a ring being cut in your lawn.
8. Pull the starting handle (Fig. A) gently until you feel a resistance, return the starting handle slowly.
9. Pull the starting handle firmly towards you to its full extent.
10. Allow the engine to reach its full running speed then gently lower the trimmer to the ground.
11. When the engine has warmed up make sure the choke control lever (H2) is in the 'normal' position.

To Stop your Trimmer

1. Move start/stop switch to stop position. See Fig K.
2. As the engine dies, tilt the trimmer to one side. See fig. M. This prevents a ring being cut in your lawn.
3. When the engine has stopped, lower the trimmer to the ground.
4. Put the handle in the Parking position (Fig. E).
5. Close the fuel tap (H1) and the fuel tank air vent screw (Fig. G).

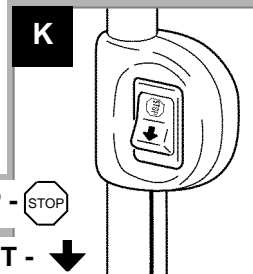
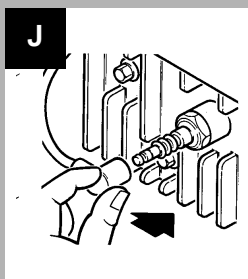
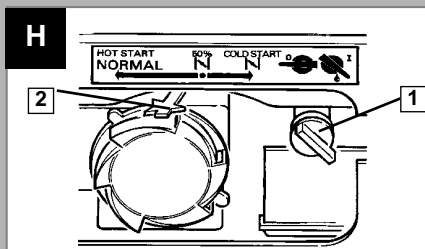
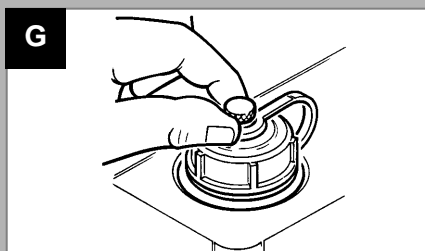

Removing and Fitting Cutting Line - Height Adjustment

N

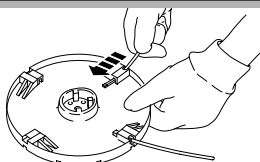

P

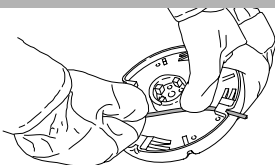

Q

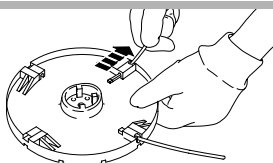

R

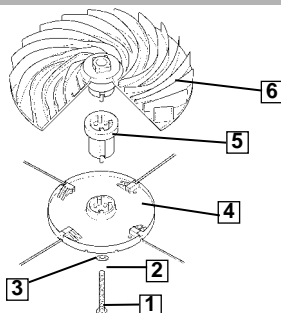

S

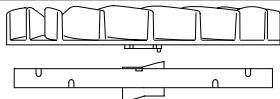

Highest
height of
cut

T



U

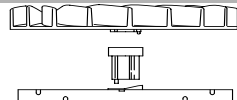

V

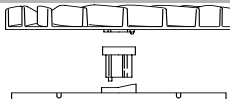

Lowest
height of
cut

- The cutting line is sharp, wear gloves and take care when handling it.
- Check the cutting line frequently during use and on completion of trimming.

Removing the Cutting Line

1. Switch machine off and disconnect spark plug lead.
2. Push the line towards the centre of the cutting disc and carefully remove. **See Fig N.**

Fitting the Cutting Line

1. Holding the line with thumb and forefinger and using other thumb as a guide, curve around centre portion of the cutting disc (as illustrated in Fig P) and thread through the hole on the rim of the cutting disc.
 2. Carefully pull the line into place as illustrated in Fig. Q.
- At all times the amount of line extending beyond the edge of disc should be of an even length. If there is a variation of more than half an inch between the four lengths of line replace immediately with four full new lengths.
 - **Important:- Only fit four cutting lines at any one time.**
 - **Only use Yellow coloured cutting line on the HVT 52.**

Changing the height of cut

1. Loosen bolt (R1), using a 14mm socket. Remove bolt (R1), spring washer (R2), washer (R3) cutting disc (R4) and spacer (R5) (if fitted).
2. Carefully remove impeller (R6) from engine shaft.
3. Select required height of cut, (See Figs S, T, U & V) and replace any cutting lines required, ensuring that cutting line is fitted on correct side of cutting disc.
- **Important:- Cutting line must be on the side of the disc facing the grass when fitted.**
4. Replace impeller (R6) on to engine shaft ensuring that it is correctly located. Replace spacer (R5) (if fitted), cutting disc (R4), washer (R3), spring washer (R2) and bolt (R1).
5. Secure assembly with bolt (R1), making sure complete assembly is tight, (if in doubt, contact your service dealer).

Caring for your Trimmer

If you do not intend to use your trimmer for long periods it is advisable to follow this procedure after use:-

1. Close the fuel tank air vent screw. **(Fig. G)**
2. The engine will begin to stop, tilt the trimmer **(Fig M)**.
3. After the engine has stopped move the start/stop switch to the stop position. **(Fig. K)**
4. Disconnect the spark plug lead **(Fig. X)** and close the fuel tap.
5. Remove all fuel from the fuel tank.

Cleaning

- **Keep your trimmer clean - grass clippings left in any of the air intakes, around the engine or under the deck could become a potential fire hazard.**
 - **Do not clean with chemicals, including petrol, or solvents - some can destroy critical plastic parts.**
1. Remove grass from under the deck with a piece of wood or similar.
 2. Using a soft brush - remove grass clippings from around the engine and from all air intakes.
 3. Remove the fan, **See 'Height adjustment'**, and clean with a soft brush.
 4. Wipe over the surface of your trimmer with a dry cloth.

Carrying your Trimmer

- **Never carry a trimmer when it is running**

Carry the trimmer at the point of balance with the cutting system facing away from you **(See Fig W)**.

Storing Your Trimmer

Store in a cool, dry, damp-proof and safe place. Service your trimmer after the last cut of the year as follows:-

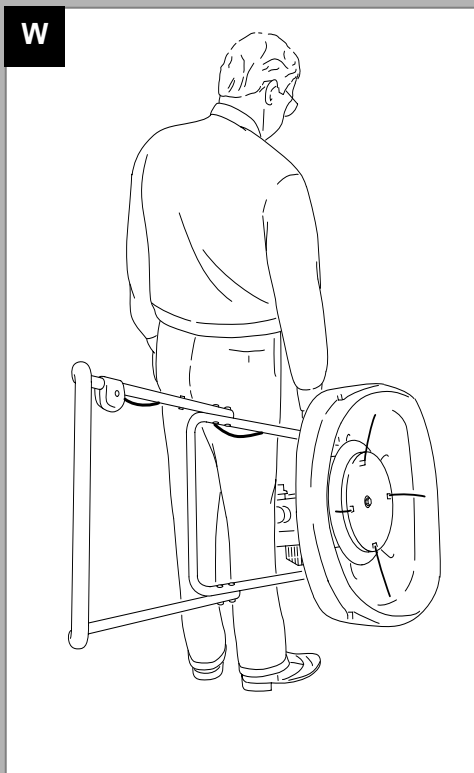

Caring for your Trimmer

X

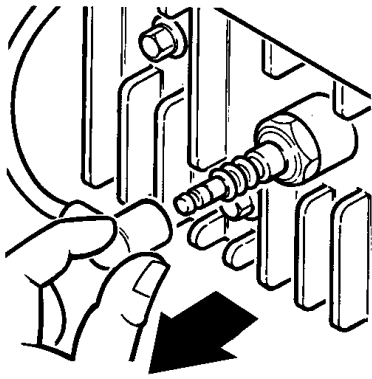

- Switch off the engine, wait until the cutting disc has stopped and disconnect the spark plug lead BEFORE attempting any maintenance or adjustment.

At the end of the Trimming Season.

1. Allow the engine to cool. Drain the fuel tank (Fuel left in the engine becomes stale and causes difficult starting).
2. Remove the spark plug lead and spark plug (See Fig X). Pour one teaspoon (5ml) of oil through the spark plug hole. Pull the starting handle 2 or 3 times. This will distribute oil on the internal surfaces of the engine. Inspect, clean and replace the spark plug. If a new spark plug is required contact your local approved Flymo Service Centre/Dealer.
3. Clean the air filter. See 'Cleaning the Air Filter'.
4. Renew the cutting disc if it is cracked, damaged or bent. Renew the disc bolt if necessary. See 'Height Adjustment' for complete instructions.
5. Use only genuine Flymo parts and accessories specified for this product.
6. Clean your trimmer thoroughly. See 'Cleaning'.
7. Your local approved **Flymo/Partner Service Centre/Dealer** will carry out any service or repairs required.
8. Store your trimmer in a cool, dry, damp-proof and safe place.

Do not re-connect the spark plug lead.

Cleaning the Air Filter

Y

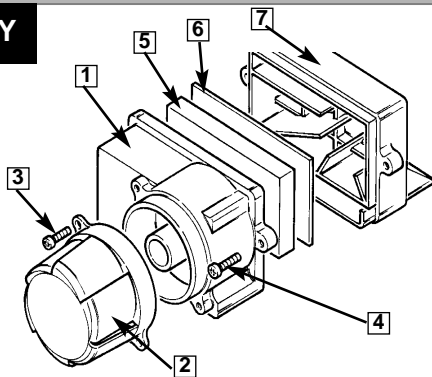

- Never run the engine without a filter or with a dirty filter. This will greatly reduce engine efficiency and lead to engine damage.

- Your Tecumseh engine is fitted with a turbo filter, the maintenance for which is as follows:-
When the engine performance drops (e.g. difficult starting or loss of revs) check the air cleaner.
1. Remove the two screws (Y4). Take off the filter cover (Y1).
 2. Remove the two filters (Y5) and (Y6). Clean inside the filter cover thoroughly.
 3. Shake or tap the thick filter (Y5) to remove any dirt or dust.
 4. Replace the thin filter (Y6) if it is contaminated with dust. **DO NOT OIL THE FILTERS.**
 5. Install the thick filter (Y5) in the filter cover (Y1). Place the thin filter (Y6) on top. **DO NOT CREASE THE FILTERS.**
 6. Clean the filter body (Y7) with a small brush. Replace the filter cover (Y1) and the two screws (Y4).
 7. **DO NOT REMOVE** the cap (Y2) or screws (Y3) unless there is visual evidence of grass or dirt.

Guarantee, Fault Finding Hints, Service Recommendations & Certificate of Conformity

Guarantee & Guarantee Policy

If any part is found to be defective due to faulty manufacture within one year of original purchase, Flymo/Partner, through its Authorised Service Repairers will effect the repair or replacement to the customer free of charge providing:

- (a) When the machine is used commercially the guarantee is 90 days.
- (b) The fault is reported directly to the Authorised Repairer.
- (c) Proof of purchase is provided.
- (d) The fault is not caused by misuse, neglect or faulty adjustment by the user.
- (e) The failure has not occurred through fair wear and tear.
- (f) The machine has not been serviced or repaired, taken apart or tampered with by any person not authorised by Flymo/Partner.
- (g) The machine has not been used for hire.
- (h) The machine is owned by the original purchaser.
- (i) The machine has not been used outside of the country for which it was specified.

* This guarantee is additional to, and in no way diminishes the customers statutory rights.

Failures due to the following are not covered, therefore it is important that you read the instructions contained in this Operator's Manual and understand how to operate and maintain your machine:

Failures not covered by guarantee

- * Replacing worn or damaged cutting lines and cutting disc.
- * Failures as a result of not reporting an initial fault.
- * Failures as a result of sudden impact.
- * Failures as a result of not using the product in accordance with the instructions and recommendations contained in this Operator's Manual.
- * Machines used for hire are not covered by this guarantee.
- * The following items listed are considered as wearing parts and their life is dependent on regular maintenance and are, therefore not normally subject to a valid warranty claim: Cutting lines, cutting disc, belts, cables, recoil ropes, filters.

Caution!

Flymo/Partner does not accept liability under the warranty for defects caused in whole or part, directly or indirectly by the fitting of replacement parts or additional parts that are not either manufactured or approved by Flymo/Partner, or by the machine having been modified in any way

Fault Finding Hints

Engine Will Not Start

1. Ensure that the start/stop switch is in the start position.
2. Check that there is sufficient fuel of the correct mix in the fuel tank, the fuel tap is open and the fuel tank air vent screw is open.
3. Check that the choke control lever is in the correct position:-
'normal' - for a hot engine
'cold start' - for a cold engine. **See Fig. H.**
4. The engine may have flooded. Remove and dry the spark plug.
5. Fuel mixture may be incorrect or stale - if so - replace with fresh mixture.
6. Check that the disc bolt is tight. A loose disc bolt could cause difficult starting.
7. **If the engine will still not start - disconnect the spark plug lead and consult your local approved Flymo/Partner Service Centre/Dealer.**

Poor Flotation or Lack of Power

1. Disconnect the spark plug lead.
2. Clean the underside of the hood, the air filter, the fan, around the engine and the air intakes.
3. Check that the engine choke control lever is in the 'normal' position (**Fig. H**).
4. Fuel mixture may be incorrect or stale - if so - replace with fresh mixture.
5. **If poor flotation or lack of power persists - disconnect the spark plug lead and consult your local approved Flymo/Partner Service Centre/Dealer.**

Excessive Vibration

1. Disconnect the spark plug lead.
2. Check that the cutting disc and cutting lines are correctly fitted. **See 'Cutting Line and Height Adjustment'.**
3. If the cutting lines or cutting disc are damaged or worn replace them with a new ones.
4. **If vibration persists - do not use - disconnect the spark plug lead and consult your local approved Flymo/Partner Service Centre/Dealer.**

Service Recommendations

To ensure the maximum life and reliability from your Flymo product we recommend that it is serviced regularly by an approved Flymo/Partner Service Centre/Dealer. They have the equipment facilities and trained personnel to advise you on the service requirements of your machine. Depending on the machine's use they will recommend one of the various types of service which are designed to ensure the maximum economic service life of your machine.

Certificate of Conformity

I, the undersigned P. Howells of Flymo/Partner, a Division of Electrolux Outdoor Products Limited, Aycliffe Industrial Estate, **NEWTON AYCLIFFE**, Co. Durham, DL5 6UP. Certify that a sample of the above product has been tested and found to comply with directives:-
89/392/EEC, 89/336/EEC

I, the undersigned P. Howells of Flymo/Partner, a Division of Electrolux Outdoor Products Limited, Aycliffe Industrial Estate, **NEWTON AYCLIFFE**, Co. Durham, DL5 6UP. Certify that a sample of the above product has been tested using directive 81/1051/EEC as a guide. The maximum A-weighted sound pressure level recorded at operator position under free field semi anechoic chamber conditions was:-

I, the undersigned P. Howells of Flymo/Partner, a Division of Electrolux Outdoor Products Limited, Aycliffe Industrial Estate, **NEWTON AYCLIFFE**, Co. Durham, DL5 6UP. Certify that a sample of the above product has been tested using ISO 5349 as a guide. The maximum weighted root mean square value of vibration recorded at operator's hand position was:-

Type	HVT52
Identification of Series	See Product Rating Label
Level	84.5 dB(A)

Type	HVT52
Identification of Series	See Product Rating Label
Value	5.41 m/s2

Signed at 
NEWTON AYCLIFFE.....1998

Signed at 
NEWTON AYCLIFFE.....1998

Signed at 
NEWTON AYCLIFFE.....1998

Flymo/Partner, a division of Electrolux Outdoor Products Ltd.,
Aycliffe Industrial Estate
NEWTON AYCLIFFE
Co.Durham DL5 6UP
ENGLAND

Telephone - (00) 44 1325 300303 Fax - (00) 44 1325 310339

UK Telephone - 01325 300303 Fax - 01325 310339

Our policy of continuous improvement means that the specification of products may be altered from time to time without prior notice. Flymo/Partner, a division of Electrolux Outdoor Products Ltd. manufacture products for a number of well known brands under various registered patents, designs and trademarks in several countries.

© Electrolux Outdoor Products Ltd. Registered Office, Electrolux Works, Oakley Road, Luton LU4 9QQ
Registered number 974979 England

5118543-02

